

PIN	DESC
1	VDD
2	GND
3	SPI_SCLK/ I2C_SCL
4	MISO/I2C_SDA
5	MOSI/I2C_SA0
6	CS/I2C_SA1
7	INT
8	PD
9	MODE
10	AUDIO_OUT
11	NC
12	NC
13	NC
14	NC
15	NC
16	NC
17	BLVDD
18	BLVDD
19	BLGND
20	BLGND

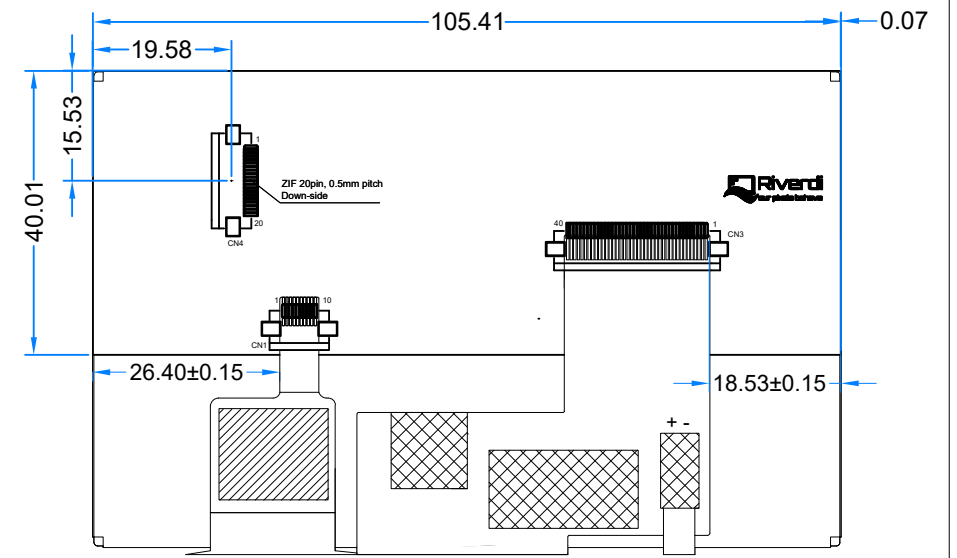

INTERNAL BACKLIGHT LED CIRCUIT DIAGRAM

DETAIL A 60:1

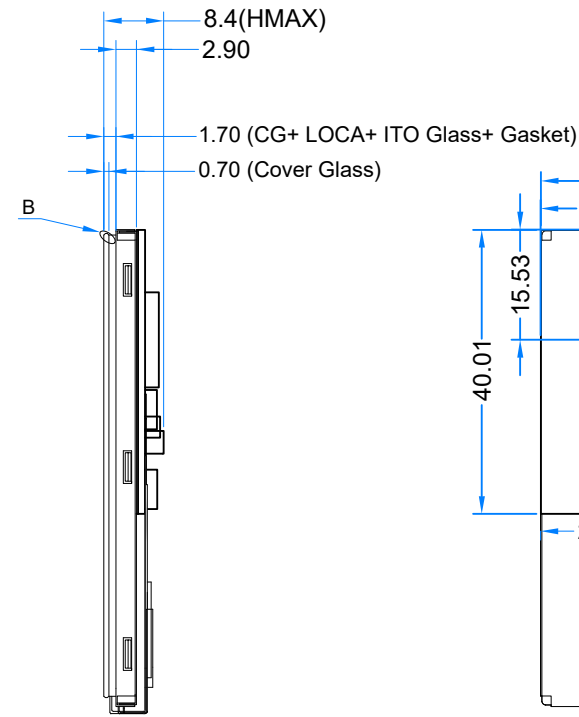
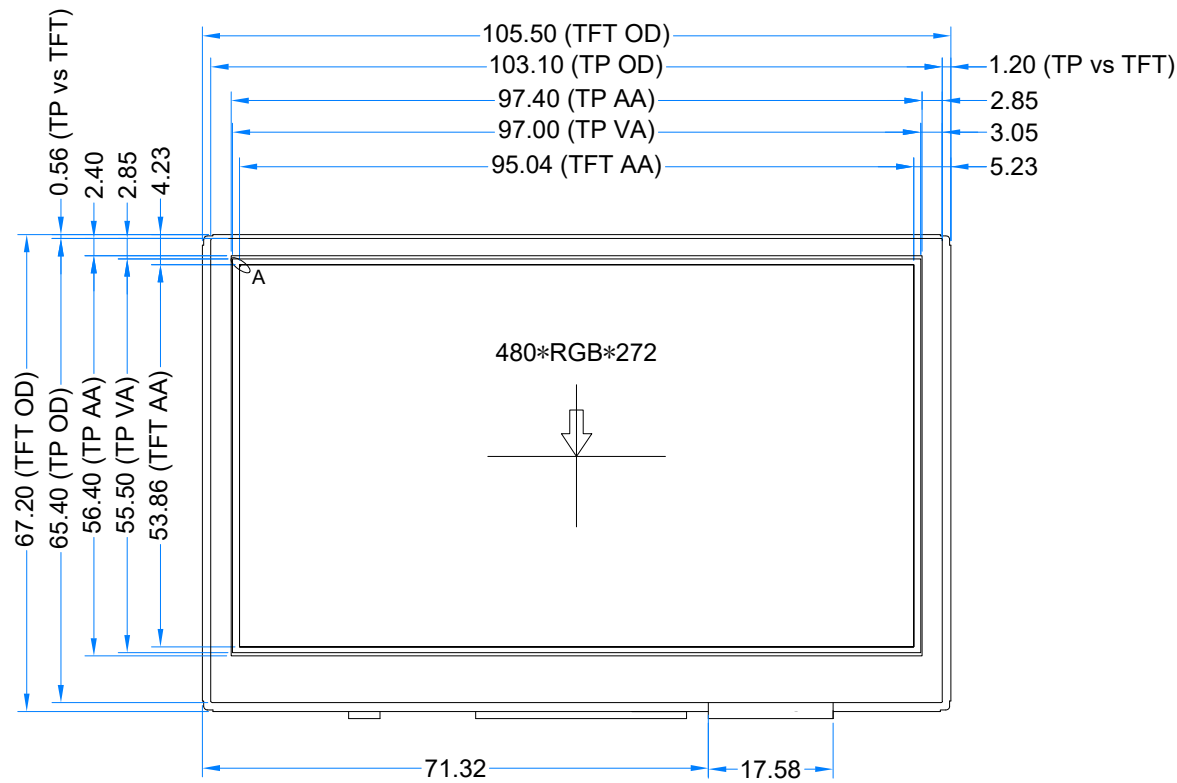
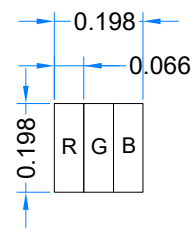

DETAIL B
SCALE 4:1

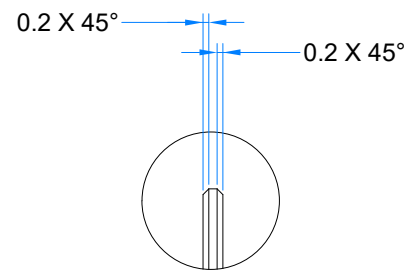

NOTES:

1. DISPLAY TYPE: TFT, TRANSMISSIVE, NORMALLY WHITE
2. OPERATION VOLTAGE: VDD=3.3V
3. VIEWING DIRECTION: 12 O'CLOCK
4. IC CONTROLLER: FT801
5. OPERATING TEMP.: -20°C ~ 70°C
6. STORAGE TEMP.: -30°C ~ 80°C
7. LED BACKLIGHT: 10-LED WHITE, BUILT-IN INVERTER
8. SURFACE LUMINANCE: 500 cd/m²
9. GENERAL TOLERANCE: ±0.2
10. RoHS COMPLIANT

Ver.	DESCRIPTION	DATE	CUSTOMER APVL	DATE	2016/02/02
1.3	Update TP dimensions and total thickness	2016.02.02	DRAWN	SCALE	1:1
1.2	Update thickness	2015.02.23	DFTG CHK	UNIT	mm
1.1	Update LED lifetime	2015.01.19	ENGR CHK	APPROVAL	MODEL
1.0	Initial case	2014.11.12			
				DWG NO	PAGE
				Rev.1.3	1/1

