

Material :

- \* Body : PA6T or PA9T With 30% GF. UL 94V-0  
Color Nature(Ivory)
- \* Slider : PA6T or PA9T With 30% GF. UL 94V-0  
Color Black
- \* Contact : Phosphor Bronze
- \* Fixed tab : Brass with Tin Plated

### Ordering Code

CF25 \*\* 1 D 0 \*0 - 05  
① ② ③ ④ ⑤ ⑥ ⑦

- ① Series No.
- ② No. of Circuits
- ③ Plating code:  
1= Matte Tin plated over Nickel  
2= Gold flash over 50μ"min. Nickel
- ④ Contact style: D= Downside contact
- ⑤ Color: 0= Nature
- ⑥ Other option: R0= Tape & Reel  
T0= Tube Packing
- ⑦ Pitch: 05= 0.50 mm

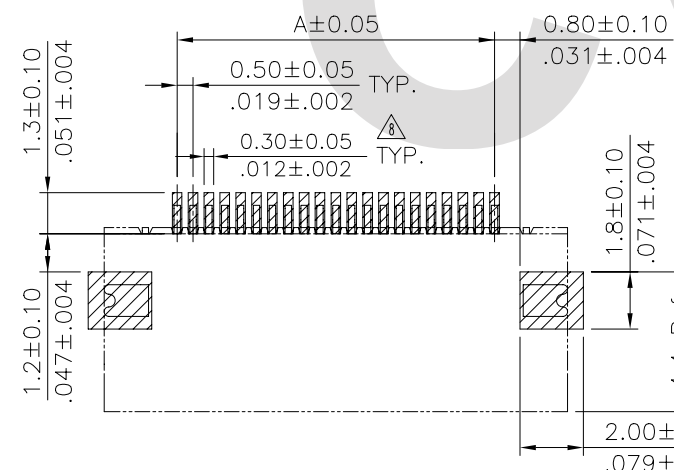
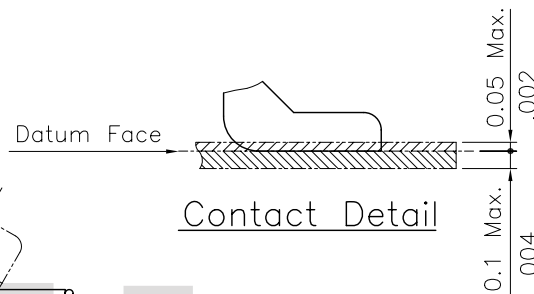
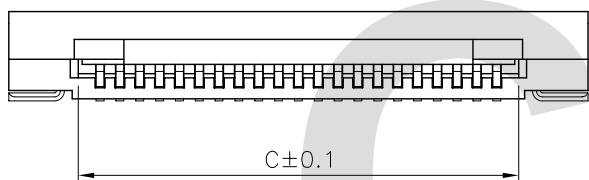

DIM.A = 0.50 x No. of Spaces  
DIM.B = DIM.A + 4.6  
DIM.C = DIM.A + 1.1

\* Available in 5 through 80 circuits

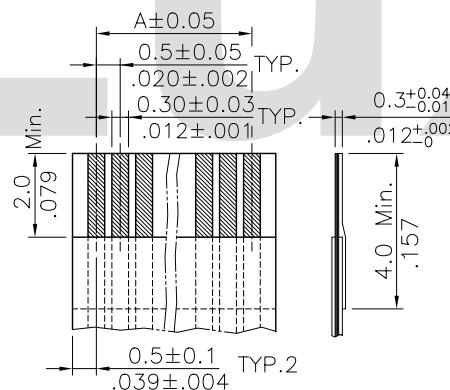

Accommodated FFC/FPC

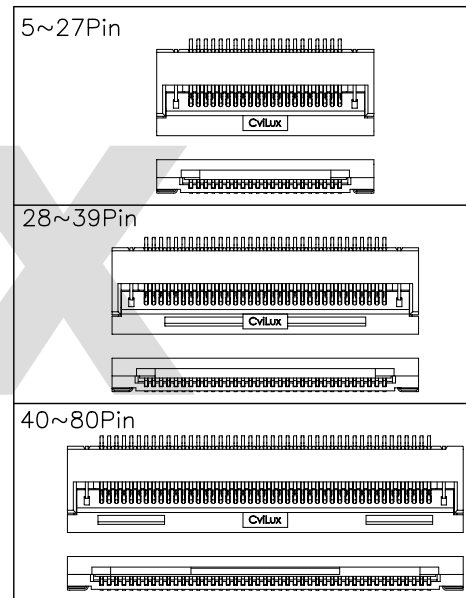

### Recommended P.C. Board Layout

Lead Free Process

RoHS compliant

⑨	Sun	12/09-08	ECN08604			DATE	UNIT: mm / inch	TITLE: 0.50mm(.020") ZIF FFC/FPC ONE-TOUCH CONNECTOR		瀚荃股份有限公司 CviLux Corporation		
⑧	Sun	12/07-07	ECN07511		DRAWN BY: Sun	12/11-08'	TOLERANCE UNLESS OTHERWISE SPECIFIED	MATERIAL:			DRAWING NO. CF2502SJ	PART NO. CF25***D0*0-05
⑦	Sandy	9/22-07	ECN07381/ECR07065-1		ENGINEER: Easley	12/18-08'	.X ± 0.15/.006 X' ± 1'	FINISH:			SCALE 5 / 1	SHEET 1 OF 2
⑥	Sun	6/15-07	ECN07246		CHECKED BY: David	12/18-08'	.XX ± 0.10/.004 X' ±					
SYM	NAME	DATE	REVISIONS		APPROVED BY: Alex	12/18-08'	.XXX ± 0.05/.002 X' ±					

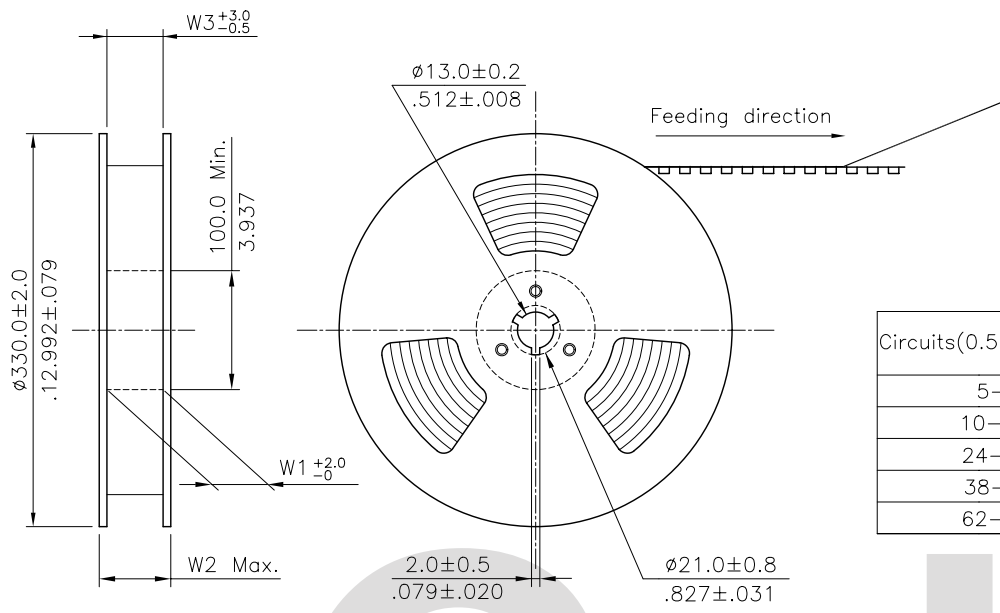

- NOTES:
1. 10 sprocket hole pitch cumulative tolerance  $\pm 0.20$
  2. Carrier camber is within 1 mm in 250 mm.
  3. Material :Transparent Anti-static Polysyrene.
  4. All dimensions meet EIA-481-2 requirements.
  5. Thickness :  $0.35 \pm 0.05$ mm.
  6. Packing length per 22" Reel : 56 Meters.
  7. Component load per 13" Reel : 2000 pcs.

Circuits(0.5mm Pitch)	Dimension					Packing (Reel/Caton)
	E	F	W1	W2	W3	
5-9	16.0(.630)	—	16.5(.650)	22.5(.885)	16.5(.650)	9
10-23	24.0(.945)	—	24.5(.965)	30.5(1.200)	24.5(.965)	8
24-37	32.0(1.260)	28.40(1.118)	32.5(1.280)	38.5(1.516)	32.5(1.280)	6
38-61	44.0(1.732)	40.40(1.596)	44.5(1.752)	50.5(1.988)	44.5(1.752)	5
62-80	56.0(2.204)	52.50(2.067)	56.5(2.224)	62.5(2.460)	56.5(2.224)	4

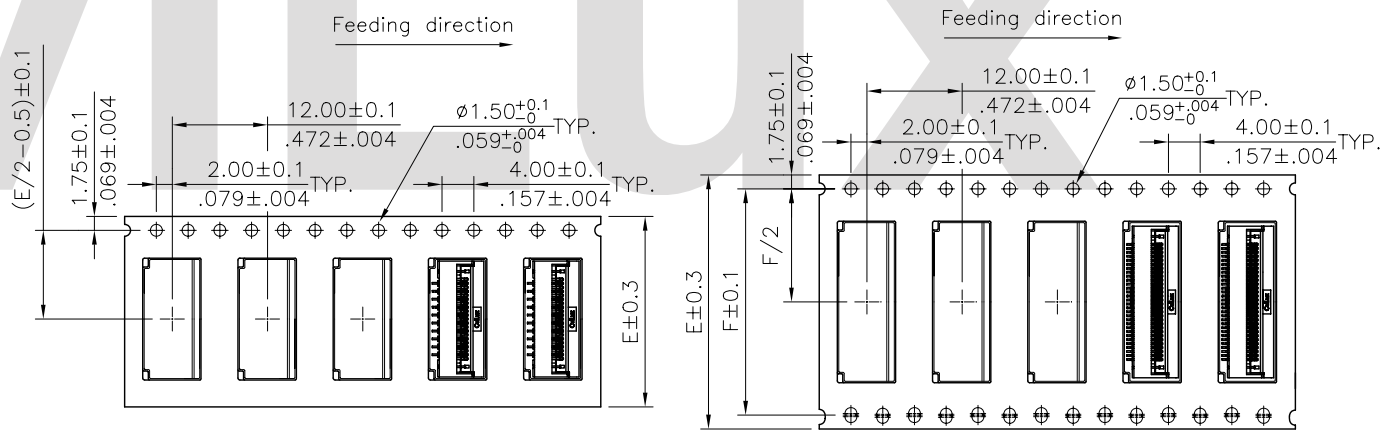
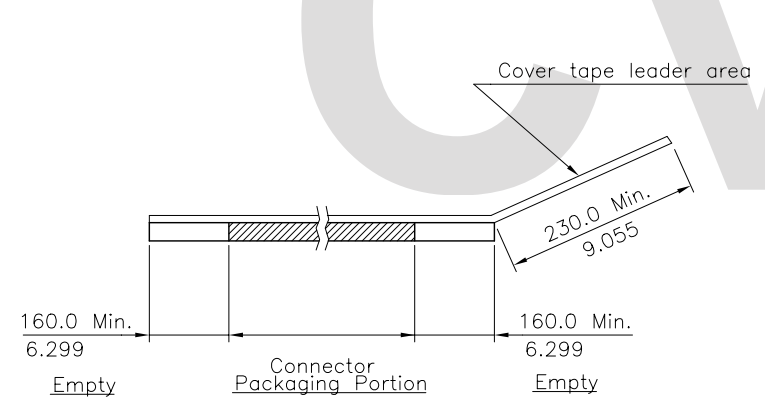

WIDTH : 16,24 mm Carrier

WIDTH : 32,44,56 mm Carrier

RoHS Compliant

SYM	NAME	DATE	REVISIONS	APPROVED BY:	DATE	UNIT: mm / inch	TITLE: 0.50mm(.020") ZIF FFC/FPC ONE-TOUCH CONNECTOR	MATERIAL:					
9	Sun	12/09-08	ECN08604					瀚荃股份有限公司 CviLux Corporation					
8	Sun	12/07-07	ECN07511		DRAWN BY:	Sun	12/11-08'	TOLERANCE UNLESS OTHERWISE SPECIFIED		DRAWING NO. CF2502SI		PART NO. CF25***D0*0-05	
7	Sandy	9/22-07'	ECN07381/ECR07065-1		ENGINEER:	Eisley	12/18-08'	.X ±	X' ±	FINISH:		SHEET 2 OF 2	
6	Sun	6/15-07'	ECN07246		CHECKED BY:	David	12/18-08'	.XX ±	.X' ±	SCALE			
				APPROVED BY:	Alex	12/18-08'	.XXX ±	.XX' ±					